



15 Artillery Terrace, Guildford GU1 4NL



**COLLINS**  
Independent Estate Agent







## 15 Artillery Terrace Guildford GU1 4NL

£529,950

Freehold

Artillery Terrace is a favourite for commuters being equally distant to both Guildford stations and a short stroll to Waitrose and North Street. The street is relatively traffic free making it ideal for young families and the schooling at the nearby Sandfield Primary is excellent as well.

- Stunning Victorian Terrace
- Close to Waitrose
- Excellent commuter location
- Downstairs WC
- Fully converted basement
- Stripped wooden flooring
- Beautiful kitchen and bathroom
- Quiet landscaped garden
- Reclaimed parquet floor to kitchen
- EPC - D







One of the finest Victorian terraces of this size to come to the market in Guildford this year. The interior is quite simply stunning with a design edge rarely seen to this detail. Features include a fully converted basement room, two further receptions and a beautiful kitchen and bathroom. The garden was landscaped in 2016 and is a real oasis in the town centre.



# COLLINS

Independent Estate Agent

Parallel House, 32 London Road  
Guildford, Surrey GU1 2AB

Telephone | 01483 230 473  
info@collinsguildford.co.uk

[www.collinsguildford.co.uk](http://www.collinsguildford.co.uk)



## Artillery Terrace, Guildford, GU1

APPROX. GROSS INTERNAL FLOOR AREA 950 SQ FT 88.2 SQ METRES (EXCLUDES STORE)

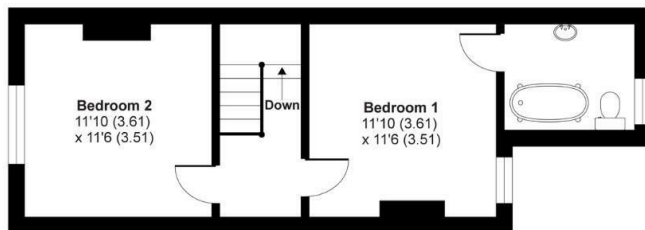

FIRST FLOOR

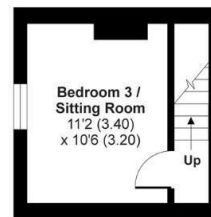

LOWER GROUND FLOOR

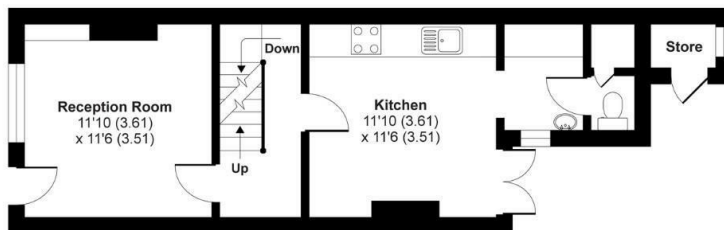

GROUND FLOOR



Whilst every attempt has been made to ensure the accuracy of the floor plan contained here, measurements of doors, windows and rooms are approximate and no responsibility is taken for any error, omission or misstatement. These plans are for representation purposes only as defined by RICS Code of Measuring Practice and should be used as such by any prospective purchaser. Specifically no guarantee is given on the total square footage of the property if quoted on this plan. Any figure given is for initial guidance only and should not be relied on as a basis of valuation.

Copyright nichecom.co.uk 2019 Produced for Mark Collins Limited REF : 508971



Important Notice To Purchasers : We endeavour to make our sales particulars accurate and reliable, however they do not constitute or form part of an offer or any contract and none is to be relied upon as statements of representation or fact. The services and appliances listed in this specification have not been tested by us and no guarantees as to their operating ability or efficiency are given. All measurements have been taken as a guide to prospective buyers only, and are not precise. If you require clarification on further information on any points, please contact us, especially if you are travelling some distance to view.